

CELL :- A352 CELL NAME:- DC MACHINE / STAGE :- Center Facing OPERATION :- Center Facing

KAIZEN THEME :- To reduce In House Rejection.

IDEA :- Poka Yoke

WIDELY/DEEPLY:-

COUNTERMEASURE :- To provide the M12 tapping in Machine Base and Make the Stud – One Side M12 Tapping and other side M10 Tapping.

PROBLEM / PRESENT STATUS :- We are the Problem Center Facing Fixture Loose due to Machine base treat wash out.

BENCHMARK	Reduce In house Rej.
TARGET	Eliminate In house rej.
KAIZEN START	18.06.16
KAIZEN FINISH	23.06.16

TEAM MEMBERS :-

Jasbir Kumar, Yogender

BENEFITS :-

- Quality Improved
- Operator Moral Increase

KAIZEN SUSTENANCE

WHAT TO DO :- Ir-reversible kaizen.

HOW TO DO :-

FREQUENCY :-

COST INCURRED FOR MAKING KAIZEN

MATERIAL COST RS.	LABOUR COST RS.	TOTAL COST RS.
1000/-	1000/-

SCOPE & PLAN FOR HORIZONTAL DEPLOYMENT

SR. NO.	CELL	TARGET	RESPONSIBILITY	STATUS
..

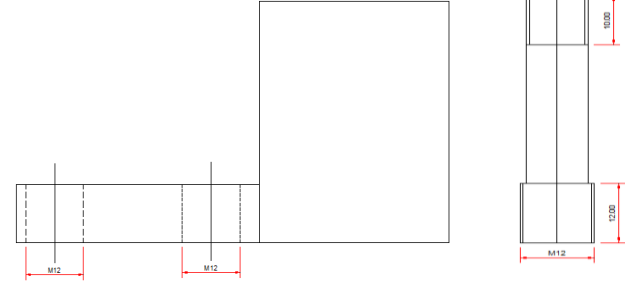
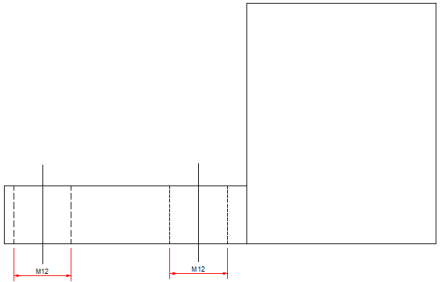

BEFORE

AFTER

WHY - WHY ANALYSIS :-
 Why :- Center Facing Fixture Loose
 Why :- Machine Base Thread Wash out.
 Why :- Fixture Change over time more
 Why :- Poka

RESULT :-

 Reduced the In house rejection

ROOT CAUSE :- Poka

REGISTRATION NO&DATE:

REGISTERED BY :- Jasbir Kumar

MANAGER'S SIGN :-